

MCH5 Classic Series manual chain hoists

0.50 to 5 metric ton lifting capacities

Features

- Compact design for limited headroom applications
- High-strength steel frame and gear case built to be durable for the rugged needs of construction and maintenance rigging
- Heat-treated spur gear is efficiently designed to provide smooth load handling and low hand chain pull
- Open frame design for self-cleaning, quick load sheave inspection and easy hoist maintenance
- Designed to international standards, non-slip load hooks and top hooks are fitted with hook latches
- Premium alloy steel grade 100 load chain
- CE certified; hoists meet or exceed regional requirements including ASME B30.16, HST-2M



MCH5 Series Specifications

Model	Capacity		# Falls	Pull to Lift Rated Load		Chain O'Hauled to Lift Load 1 ft		Chain Size mm	Chain Weight per Foot		Shipping Weight with 10' of Lift	
	lb	metric tons		lb	kg	ft	m		lb	kg	lb	kg
MCH5-005	1,100	0.50	1	59	26.8	25	7.6	5 x 15	0.4	0.2	20	9.1
MCH5-010	2,200	1	1	76	34.5	39	11.9	6.3 x 19.2	0.6	0.3	26	11.8
MCH5-015	3,300	1.50	1	78	35.5	58	17.7	7.1 x 21.2	0.7	0.3	45	20.5
MCH5-020	4,400	2	1	80	36.4	75	22.9	8 x 24.2	1	0.5	50	22.7
MCH5-030	6,600	3	2	81	36.8	116	35.4	7.1 x 21.2	1.5	0.7	52	23.6
MCH5-050	11,000	5	2	89	40.5	187	57	9 x 27.2	2.4	1.1	94	42.7

MCH5 Series Dimensions (in)

Model	A (min)	B	C	D
MCH5-005	12	5.7	5	1.1
MCH5-010	13.6	6.2	5.8	1.2
MCH5-015	14.6	6.9	5.8	1.4
MCH5-020	16.8	8	7	1.4
MCH5-030	19.9	8.1	5.8	1.7
MCH5-050	25	10.4	7	1.9

Note: Dimensions are subject to change.

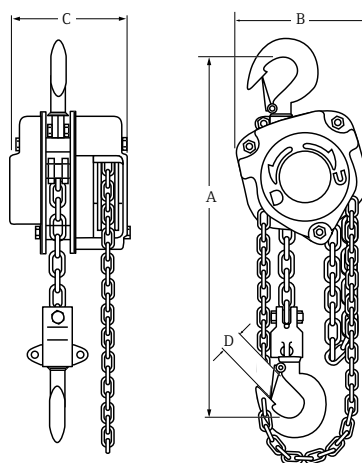

► HOW TO ORDER

Example: Base Model - Lift - Hand Chain Drop Option
MCH5-010- - 20 - 18 B

S*COR*E hand chain = H

S*COR*E load chain = N

Fabric chain container = S

Bullard bottom hook = B (available up to 2 ton only)

Note: S*COR*E options provide improved protection, durability and performance for hoist operating in corrosive or harsh environments or where additional spark resistance is desirable.