

SQUARE 40X40

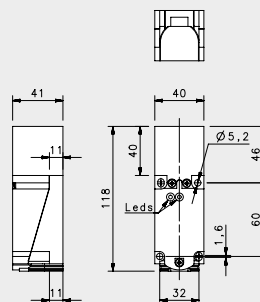

40X40

NOMINAL SWITCHING DISTANCE

| | | | | FLUSH | | NON FLUSH | |
|-----------------|----------------|----------|-----------|----------------|-----------|----------------|-----------|
| | | | | Terminal Block | | Terminal Block | |
| | | | | 15 mm | | 30mm | |
| 10-30 Vdc | PNP/NPN NO-NC | 4 wires | order No. | --- | --- | --- | --- |
| 10-30 Vdc | PNP NO | 3 wires | order No. | --- | --- | --- | --- |
| 10-30 Vdc | PNP NC | 3 wires | order No. | --- | --- | --- | --- |
| 10-30 Vdc | NPN NO | 3 wires | order No. | --- | --- | --- | --- |
| 10-30 Vdc | NPN NC | 3 wires | order No. | --- | --- | --- | --- |
| 10-30 Vdc | PNP NO-NC | 4 wires | order No. | IS-40-W5-S3 | 95B065240 | IS-40-Y5-S3 | 95B065280 |
| 10-30 Vdc | NPN NO-NC | 4 wires | order No. | IS-40-W6-S3 | 95B065230 | IS-40-Y6-S3 | 95B065270 |
| 10-30 Vdc | NO-NC | 2 wires | order No. | --- | --- | --- | --- |
| 20-250 Vac/Vdc | NO | 2 wires | order No. | --- | --- | --- | --- |
| 20-250 Vac/Vdc | NC | 2 wires | order No. | --- | --- | --- | --- |
| 20-250 Vac | NO | 2/3wires | order No. | --- | --- | --- | --- |
| 10-30 Vdc | Analog 0-20 mA | 3 wires | order No. | --- | --- | --- | --- |
| NAMUR amplifier | NAMUR | 2 wires | order No. | --- | --- | --- | --- |

| | | |
|---------------------------|---|---|
| Nominal Voltage | 10-30 Vdc | 10-30 Vdc |
| Residual Ripple | < 10% | < 10% |
| Hysteresis | < 15% (Sr) | < 15% (Sr) |
| Max. Output Current | 200mA | 200mA |
| Min. Output Current | --- | --- |
| Residual Current | < 0,01 mA | < 0,01 mA |
| Voltage Drop | < 1,5V | < 1,5V |
| Operation Led | YES | YES |
| Switching Frequency | 100 Hz | 100 Hz |
| Start Up Delay | --- | --- |
| Repeatability | < 1.0% (Sr) | < 1.0% (Sr) |
| Short Circuit Protection | Present (self-resetting) | Present (self-resetting) |
| Electric Protection | Against polarity reversal inductive loads | Against polarity reversal inductive loads |
| Temperature Limit | (-25 ... +75°C) | (-25 ... +75 °C) |
| Protection Degree | IP67 | IP67 |
| Cable Length | --- | --- |
| Cable Section | --- | --- |
| Housing Material | PBT (RESIN) | PBT (RESIN) |
| Weight - Cable Output | --- | --- |
| Weight - Connector Output | 262g | 262g |

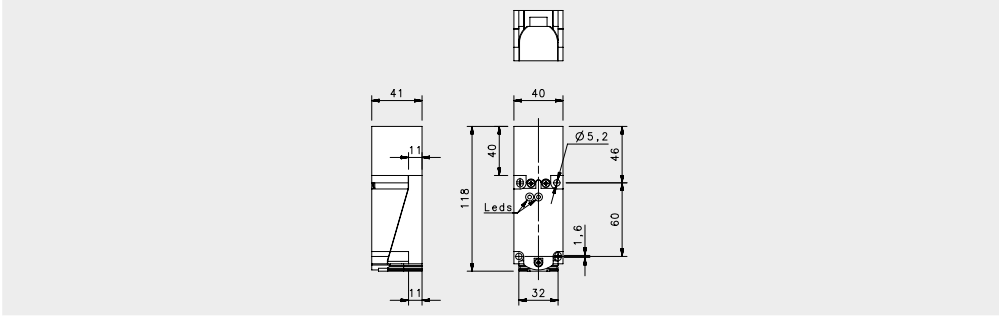

| 40X40 VAC/VDC | |
|---------------|-----------|
| FLUSH | NON FLUSH |

[illegible]

SQUARE 40X40

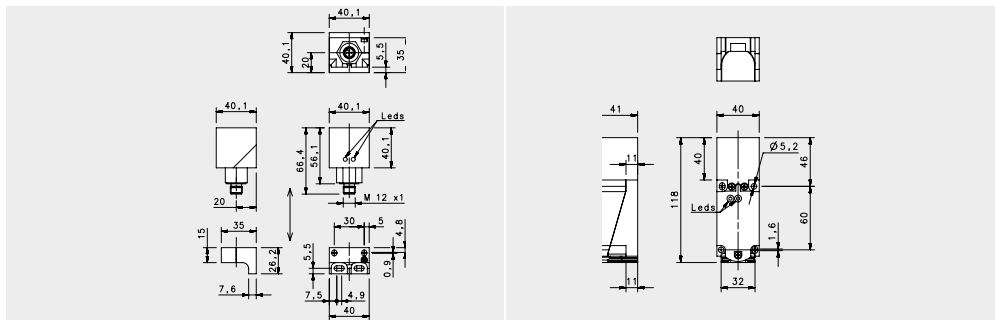

| SHORT | ANALOG OUTPUT |
|-------|---------------|
| FLUSH | NON FLUSH |

M12 conn.

Terminal Block

15mm

7-20mm

NOMINAL SWITCHING DISTANCE

| 10-30 Vdc | PNP/NPN NO-NC | 4 wires | order No. | --- | --- |
|-----------------|----------------|-----------|-----------|--------------------------|---------------------------|
| 10-30 Vdc | PNP NO | 3 wires | order No. | --- | --- |
| 10-30 Vdc | PNP NC | 3 wires | order No. | --- | --- |
| 10-30 Vdc | NPN NO | 3 wires | order No. | --- | --- |
| 10-30 Vdc | NPN NC | 3 wires | order No. | --- | --- |
| 10-30 Vdc | PNP NO-NC | 4 wires | order No. | IS-40-X5-S2 95B065320 | --- |
| 10-30 Vdc | NPN NO-NC | 4 wires | order No. | IS-40-X6-S2 95B065310 | --- |
| 10-30 Vdc | NO-NC | 2 wires | order No. | --- | --- |
| 20-250 Vac/Vdc | NO | 2 wires | order No. | --- | --- |
| 20-250 Vac/Vdc | NC | 2 wires | order No. | --- | --- |
| 20-250 Vac | NO | 2/3 wires | order No. | --- | --- |
| 10-30 Vdc | Analog 0-20 mA | 3 wires | order No. | --- | IS-40-C11-S3 95B065330 |
| NAMUR amplifier | NAMUR | 2 wires | order No. | --- | --- |

| Nominal Voltage | 10-30 Vdc | 18-30 Vdc |
|---------------------------|---|---|
| Residual Ripple | < 10% | < 10% |
| Hysteresis | < 15% (Sr) | < 10% (Sr) |
| Max. Output Current | 200mA | 0-20mA/200 Ω Max. |
| Min. Output Current | --- | --- |
| Residual Current | < 0,01mA | --- |
| Voltage Drop | < 1,5V | --- |
| Operation Led | YES | --- |
| Switching Frequency | 100 Hz | 100 Hz |
| Start Up Delay | --- | --- |
| Repeatability | < 1.0% (Sr) | 0,02 mm |
| Short Circuit Protection | Present (self-resetting) | Present (self-resetting) |
| Electric Protection | Against polarity reversal inductive loads | Against polarity reversal inductive loads |
| Temperature Limit | (-25... +70 °C) | (-25 ... +70 °C) |
| Protection Degree | IP67 | IP67 |
| Cable Length | --- | --- |
| Cable Section | --- | --- |
| Housing Material | PBT (RESIN) | PBT (RESIN) |
| Weight - Cable Output | --- | --- |
| Weight - Connector Output | 170 g | 242g |

SQUARE 8X8

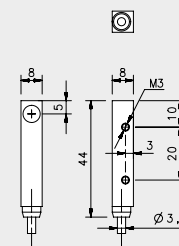
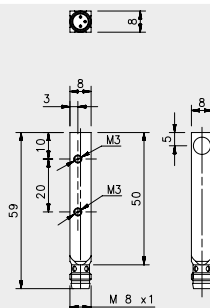

SHORT

FLUSH

NOMINAL SWITCHING DISTANCE

| | | | | M8 conn 1,5mm | cable 1,5mm |
|-----------------|-------------------|-----------|-----------|--------------------------|--------------------------|
| 10-30 Vdc | PNP/NPN NO-NC | 4 wires | order No. | --- | --- |
| 10-30 Vdc | PNP NO | 3 wires | order No. | IS-88-Q1-S1 95B060840 | IS-88-Q1-03 95B060830 |
| 10-30 Vdc | PNP NC | 3 wires | order No. | --- | --- |
| 10-30 Vdc | NPN NO | 3 wires | order No. | --- | --- |
| 10-30 Vdc | NPN NC | 3 wires | order No. | --- | --- |
| 10-30 Vdc | PNP NO-NC | 4 wires | order No. | --- | --- |
| 10-30 Vdc | NPN NO-NC | 4 wires | order No. | --- | --- |
| 10-30 Vdc | NO-NC | 2 wires | order No. | --- | --- |
| 20-250 Vac/Vdc | NO | 2 wires | order No. | --- | --- |
| 20-250 Vac/Vdc | NC | 2 wires | order No. | --- | --- |
| 20-250 Vac | NO | 2/3 wires | order No. | --- | --- |
| 10-30 Vdc | Analog 0-20 mA | 3 wires | order No. | --- | --- |
| NAMUR amplifier | NAMUR | 2 wires | order No. | --- | --- |

| | | |
|---------------------------|--|--|
| Nominal Voltage | 10-30 Vdc | 10-30 Vdc |
| Residual Ripple | < 10% | < 10% |
| Hysteresis | < 10% (Sr) | < 10% (Sr) |
| Max. Output Current | 200mA | 200mA |
| Min. Output Current | --- | --- |
| Residual Current | --- | --- |
| Voltage Drop | < 1,2V | < 1,2V |
| Operation Led | Yellow | Yellow |
| Switching Frequency | 500 Hz | 500 Hz |
| Start Up Delay | 75 ms | 75 ms |
| Repeatability | < 3% | < 3% |
| Short Circuit Protection | Present (self-resetting) | Present (self-resetting) |
| Electric Protection | Against polarity reversal inductive loads | Against polarity reversal inductive loads |
| Temperature Limit | (-25 ... +70 °C) | (-25 ... +70 °C) |
| Protection Degree | IP67 | IP67 |
| Cable Length | --- | 2 m |
| Cable Section | --- | 3x0,14mm ² |
| Housing Material | nickel-plated brass | nickel-plated brass |
| Weight - Cable Output | --- | 80 g |
| Weight - Connector Output | 40 g | --- |