



Series TT02 Torque Tool Testers present a simple and accurate solution for testing manual, electric, and pneumatic torque screwdrivers, wrenches, and other tools. These testers are compact and rugged, suitable for production environments. A universal 3/8" square receptacle accepts common bits and attachments. The TT02 captures peak torque in both measurement directions, and also calculates 1st and 2nd peaks, useful for click-type tools.

A blazingly fast sampling rate of 7,000 Hz and accuracy of $\pm 0.3\%$ produce reliable and consistent test results. The TT02 includes a range of sophisticated productivity-enhancing features, including USB, RS-232, Mitutoyo, and analog outputs, automatic data output/zeroing/data storage upon tool slip or click, memory storage for 1,000 readings, pass/fail indicators and outputs, and more. Password protection is provided to prevent unauthorized changes to settings and calibration.

Series TT02 testers include MESUR™ Lite data acquisition software. MESUR™ Lite tabulates continuous or single point data. Data stored in the TT02's memory can also be downloaded in bulk. One-click export to Excel allows for further data manipulation.

Note: Not for use with impact tools.

MESUR Lite data acquisition software is included with Series TT02 testers

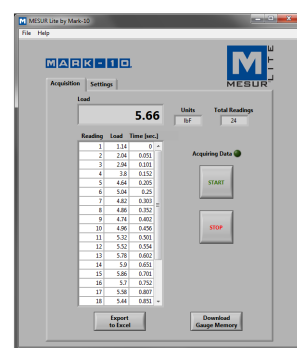

Features

- First / second peak capture for CW and CCW directions
- 3/8" square receptacle accommodates common bits and attachments
- High-speed 7,000 Hz sampling rate accurately captures peak torque values
- 1,000-point data memory with statistics and outputs
- USB, RS-232, Mitutoyo, and analog outputs
- Break detection: automatic output, data storage, and zeroing upon tool click/slip automates testing processes
- Programmable set point indicators and outputs for pass/fail determination
- Password protection prevents unauthorized changes
- 5 selectable units of measurement
- MESUR™ Lite data collection software included

Controls & Indicators



Mark-10 Corporation ■ www.mark-10.com ■ info@mark-10.com
Toll-free: 888-MARK-TEN ■ Tel: 631-842-9200 ■ Fax: 631-842-9201



Optional Items



◀ **AC1026-1 Rundown fixture**
Helps capture readings for electric and pneumatic tools from 0 to 50 lbFin [0 to 5.7 Nm]



◀ **AC1026-2 Rundown fixture**
Helps capture readings for electric and pneumatic tools from 50 to 100 lbFin [5.7 to 11.5 Nm]



ST001 Bench mounting kit
Mounts the TT02 securely to a bench for horizontal orientation.



ST002 Carrying case
Provides storage space for the TT02 tester, rundown fixtures, bench mounting kit, AC adapter, and accessories.

Specifications

| | |
|------------------------------------|--|
| Accuracy: | ±0.3% of full scale |
| Sampling Rate: | 7,000 Hz |
| Power: | AC or rechargeable battery. Multi-step low battery indicator is displayed, tester shuts off automatically when power is too low. |
| Battery life: | Backlight on: up to 7 hours of continuous use Backlight off: up to 24 hours of continuous use |
| Units: | ozFin, lbFin, lbFft, Nm, Ncm |
| Outputs: | USB / RS-232: Configurable up to 115,200 baud. Mitutoyo: Serial BCD suitable for all Mitutoyo SPC-compatible devices. Analog: ±1 VCD, ±0.25% of full scale at capacity. General purpose: Three open drain outputs, one input. Set points: Three open drain lines. |
| Configurable settings: | 1st/2nd peak, digital filters, outputs, automatic shutoff, default settings, key tones, backlight, audio alarms, passwords, calibration |
| Safe overload: | 150% of full scale (display shows "OVER" at 110% and above) |
| Weight: | 5.8 lb [2.6 kg] |
| Included items: | 1/4" hex to 3/8" square adapter, universal voltage AC adapter, battery, quick-start guide, USB cable, resource CD (USB driver, MESUR™ Lite software, MESUR™ gauge DEMO software, and user's guide), and NIST-traceable certificate of calibration (cert with data is available for an additional charge). |
| Environmental requirements: | 40 - 100°F, max. 96% humidity, non-condensing |
| Warranty: | 3 years (see individual statement for further details) |

Dimensions in [mm]

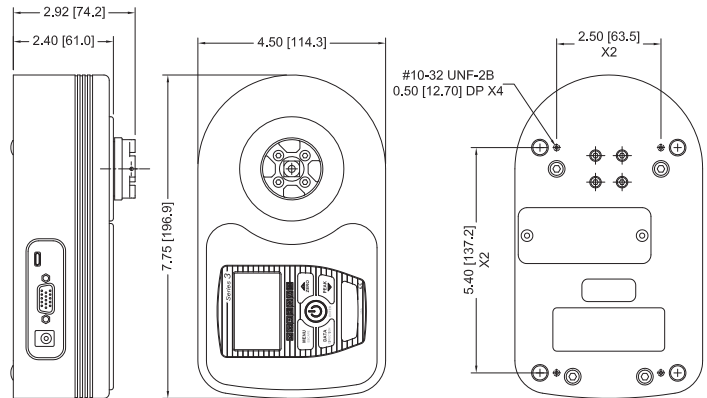

RECEPTACLE TOP VIEW:

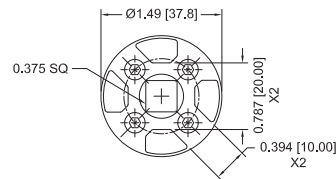

Capacity x Resolution

| Model No. | ozFin | lbFin | lbFft | Ncm | Nm |
|-----------|-----------|------------|------------|------------|--------------|
| MTT02-12 | 192 x 0.1 | 12 x 0.005 | 1 x 0.0005 | 135 x 0.1 | 1.35 x 0.001 |
| MTT02-25 | 400 x 0.2 | 25 x 0.01 | 2 x 0.001 | 290 x 0.2 | 2.9 x 0.002 |
| MTT02-50 | 800 x 0.5 | 50 x 0.02 | 4 x 0.002 | 570 x 0.5 | 5.7 x 0.005 |
| MTT02-100 | 1600 x 1 | 100 x 0.05 | 8 x 0.005 | 1150 x 0.5 | 11.5 x 0.005 |

All models include 110V AC adapters. Add suffix 'E' for euro plug (220V), 'U' for UK plug (220V), or 'A' for Australian plug (220V).

Ex: MTT02-12E, MTT02-50U, MTT02-100A