

- LSF07 is a high speed model for precise grinding and polishing. LSF 07 is equipped with a 3 mm collet and can be equipped with a 1/8" collet as optional. (Without speed governor)
- LSF18 series – All the models in the 18 series are equipped with a powerful 0.5 kW air motor and speed governor. The angled models (LSV) have a patented solution that overcomes temperature and leakage problems commonly associated with angle head tools. The result is a leak-free and self-cooled angle head. All models are lubrication free except for the high speed model LSF18 S460.
- LSF28 series – Powerful 0.85 kW air motor, with speed governor and scatter damping. Impressive power-to-weight ratio.
- LSF38 – One of the most powerful one hand die grinder on the market, up to 1.35 kW. If you are looking for a tool that can boost your productivity and save you money, the LSF38 is the right tool! The die grinders in the 38 series are lubrication free with scatter damping for maximum operator comfort and safety.



Model	Rec. max dia of			Max output kW	Max output hp	Weight kg	Length mm	Air consumption at				Rec. hose size mm	Air inlet thread BSP	Ordering No. with collet		
	Max speed r/min	Tungsten free burrs mm	Mount- ed point mm					max output l/s	free speed cfm	free speed l/s	free speed cfm			6 mm	1/4"	
<b>Straight models</b>																
LSF18 S460E-1R	46000	9	16	0.51	0.68	0.7	1.5	291	11.4	24	15.0	31.5	10	3/8	1/4	8423 1224 12
LSF18 S460-1 <sup>a</sup>	46000	9	16	0.51	0.68	0.5	1.1	193	11.4	24	15.0	31.5	10	3/8	1/4	8423 1224 04
LSF18 S460E-1 <sup>a</sup>	46000	9	16	0.51	0.68	0.7	1.5	291	11.4	24	15.0	31.5	10	3/8	1/4	8423 1224 09
LSF18 S300	30000	12	20	0.50	0.67	0.5	1.1	193	11.3	23.7	6.6	13.8	10	3/8	1/4	8423 1224 03 8423 1224 06
LSF18 S300/R	30000	12	20	0.50	0.67	0.5	1.1	193	11.3	23.7	6.6	13.8	10	3/8	1/4	8423 1224 11
LSF18 S300E-1	30000	12	20	0.50	0.67	0.7	1.5	291	11.3	23.7	6.6	13.8	10	3/8	1/4	8423 1224 08
LSF18 S300E-1/R	30000	12	20	0.50	0.67	0.7	1.5	291	11.3	23.7	6.6	13.8	10	3/8	1/4	8423 1224 10
LSF18 S200	20000	12	20	0.50	0.54	0.5	1.1	193	9.6	20.1	3.5	7.4	10	3/8	1/4	8423 1224 02 8423 1224 05
LSF18 S200E-1	20000	12	20	0.50	0.54	0.7	1.5	291	9.6	20.1	3.5	7.4	10	3/8	1/4	8423 1224 07
LSF28 S250 <sup>a</sup>	25000	12	32	0.86	1.15	0.75	1.65	210	18.5	39.2	11.0	23.3	10	3/8	3/8	8423 1235 11
LSF28 S250E <sup>a</sup>	25000	12	32	0.86	1.15	1.25	2.75	335	18.5	39.2	11.0	23.3	10	3/8	3/8	8423 1235 60
LSF28 S250E-R <sup>a</sup>	25000	12	32	0.86	1.15	1.25	2.75	335	18.5	39.2	11.0	23.3	10	3/8	3/8	8423 1235 49
LSF28 S250-R <sup>a</sup>	25000	12	32	0.86	1.15	0.75	1.65	210	18.5	39.2	11.0	23.3	10	3/8	3/8	8423 1235 48
LSF28 S180 <sup>a</sup>	18000	16	40	0.82	1.10	0.75	1.65	210	17.4	36.9	11.0	23.3	10	3/8	3/8	8423 1235 04
LSF28 S180E <sup>a</sup>	18000	16	40	0.82	1.10	1.25	2.75	335	17.4	36.9	7.0	14.8	10	3/8	3/8	8423 1235 05
LSF28 S180E-1R <sup>a</sup>	18000	16	40	0.82	1.10	1.25	2.75	335	17.4	36.9	7.0	14.8	10	3/8	3/8	8423 1235 42
LSF28 S180-1R <sup>a</sup>	18000	16	40	0.82	1.10	0.75	1.65	210	17.4	36.9	7.0	14.8	10	3/8	3/8	8423 1235 41
LSF28 S150 <sup>a</sup>	15000	16	40	0.70	0.94	0.75	1.65	210	15.0	31.8	5.5	11.7	10	3/8	3/8	8423 1235 64
LSF28 S150E <sup>a</sup>	15000	16	40	0.70	0.94	1.25	2.75	335	15.0	31.8	4.3	9.1	10	3/8	3/8	8423 1235 61
LSF28 S120 <sup>a</sup>	12000	16	40	0.66	0.89	0.75	1.65	210	13.8	29.3	4.0	8.5	10	3/8	3/8	8423 1235 67
LSF38 S250E-01 <sup>a</sup>	25000	16	40	1.35	1.8	1.5	3.3	352	28	58	25	53	13	1/2	3/8	8423 1231 17
LSF38 S180E-01	18000	16	40	1.35	1.8	1.5	3.3	352	28	58	15	31	13	1/2	3/8	8423 1231 16
LSF38 S180E-01/R	18000	16	40	1.35	1.8	1.5	3.3	356	28	58	15	31	13	1/2	3/8	8423 1231 15
LSF38 S150E-01/R	15000	16	40	1.25	1.7	1.5	3.3	356	24	50	13	27	13	1/2	3/8	8423 1231 14
<b>Angle grinders</b>																
LSV18 S200-1	20000	12	20	0.46	0.61	0.6	1.3	185	11	23	7	14.7	10	3/8	1/4	8423 0111 11
LSV18 S120-1	12000	12	20	0.46	0.61	0.6	1.3	185	11	23	7	14.7	10	3/8	1/4	8423 0111 13
LSV18 S080-1	8000	12	20	0.37	0.5	0.6	1.3	185	11	23	6.5	13.6	10	3/8	1/4	8423 0111 16
LSV28 S150	15000	16	40	0.68	0.91	1.15	2.53	250	17.0	36.0	8.3	17.6	10	3/8	3/8	8423 0125 54
<b>Grinders for polishing</b>																
LSF28 ST030	3000	–	–	0.67	0.90	1.16	2.55	275	18.0	38.2	8.6	18.2	10	3/8	3/8	8423 1235 63
LSF28 ST030E	3000	–	–	0.67	0.90	1.76	3.87	400	18.0	38.2	8.6	18.2	10	3/8	3/8	8423 1235 62
LSF28 ST070 <sup>a</sup>	7000	–	–	0.76	1.02	1.16	2.55	275	18.9	40.1	12.4	26.3	10	3/8	3/8	8423 1235 66
LSF28 ST070E <sup>a</sup>	7000	–	–	0.76	1.02	1.76	3.87	400	18.9	40.1	12.4	26.3	10	3/8	3/8	8423 1235 65
<b>High speed pen model</b>																
LSF07 S850	88000	4	6	0.10	0.13	0.4	0.9	170	2.2	4.9	2.3	4.6	4.5	3/16	–	8423 1222 03

<sup>a</sup> Not lubrication-free. -1 = 6 mm collet

E = Extended version

R = Model is rigid, without scatter damping

Accessories Included

**LSF07**

Air hose  
ErgoNIP 08  
Collet 3 mm (1. se ill.)

**LSF/LSV/18/28**

Spanner  
Collet 6 mm (1. se ill.)  
Air hose, air hose nipple and clamp  
Exhaust hose

**LSF38**

Air hose nipple  
Collet 6 mm (1. se ill.)

Optional Accessories

	LSF07	LSF/LSV18	LSF/LSV28	LSF38	See ill.
<b>Optional collets</b>					
Collet 1/8"	4150 1822 00	-	-	-	3
Collet 3 mm	-	4150 0081 00	4150 0081 00	-	3
Collet 6 mm	-	4150 0075 00	4150 0075 00	-	3
Collet 8 mm	-	4150 0074 00	4150 0074 00	-	3
Collet 1/4"	-	4150 0076 00	4150 0076 00	4150 1754 00	3
Collet 10 mm	-	-	-	4150 0681 00	3
Collet nut	-	4150 0760 00	4150 0760 00	4150 0849 00	3
Extension 75 mm /3 in	-	4150 0674 00 <sup>a</sup>	4150 0674 00 <sup>a</sup>	-	4
<b>For machining of plastic and glas fibre</b>					
Diamond burr Ø 6 mm	-	3780 5013 70	-	-	2
Diamond drum Ø 27 mm	-	3780 5033 00	-	-	5
Diamond drum Ø 50 mm	-	-	3780 5035 00	-	5
Spot suction kit for burr (burr not included)	-	3780 3015 22	3780 4007 41	-	6
Spot suction kit for drum (drum not included)	-	3780 4011 61 <sup>b</sup>	3780 4011 71 <sup>c</sup>	-	6

<sup>a</sup> Only for rigid (-R) models  
<sup>b</sup> For use with 6 mm collet  
<sup>c</sup> For use with 8 mm collet

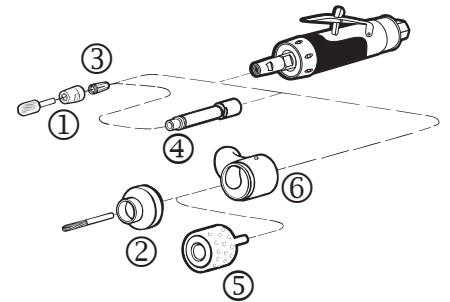

Productivity Kits

Model	Air inlet BSP	Max air flow	Hose, 5 m	Coupling	Lubrication	Ordering No.
MIDI Optimizer F/RD EQ10-R13-W, incl. whiphose	3/8	23 l/s	Rubair 13 mm	ErgoQIC 10	Yes	8202 0850 14
MIDI Optimizer F/RD EQ10-R13-W, incl. whiphose	-	23 l/s	Rubair 13 mm	ErgoQIC 10	Yes	8202 0850 15
MIDI Optimizer F/RD EQ10-T13	3/8	35 l/s	Turbo 13 mm	ErgoQIC 10	Yes	8202 0850 17
MIDI Optimizer F/R EQ10-T13	1/2	35 l/s	Turbo 13 mm	ErgoQIC 10	No	8202 0850 04
MIDI Optimizer F/RD EQ10-T13	1/2	35 l/s	Turbo 13 mm	ErgoQIC 10	Yes	8202 0850 13
MIDI Optimizer F/RD EQ10-T16	1/2	40 l/s	Turbo 16 mm	ErgoQIC 10	Yes	8202 0850 12
MAXI F/R C-T16	1/2	60 l/s	Turbo 16 mm	Claw	No	8202 0850 05
MAXI F/RD C-T20	1/2	65 l/s	Turbo 20 mm	Claw	No	8202 0850 20



Service Kits

07 series	4081 0243 90
18 series	4081 0355 90
28 series	4081 0315 90
38 series	4081 0308 90